

State of Carolina 96 District 909
 on the East side of the ancient Boundary
 Pursuant to a Warrant from John
 Thomas Esq^r Commissioner of Locations
 Bearing date August the 1st 1784 I have ad-
 measured & laid out unto William Stirling
 a Tract of land containing three Hundred & fifty
 acres lying on Bullman's Creek bounded to the
 N^W by Alex^r Elders land & by Robert Elders & by
 Isaac Patton & Thomas Cornistons land N^E by
 Vacant Land & the Publick Shape and measure
 as the annexed plat represents Survey
 The first day of 1784 Certified by

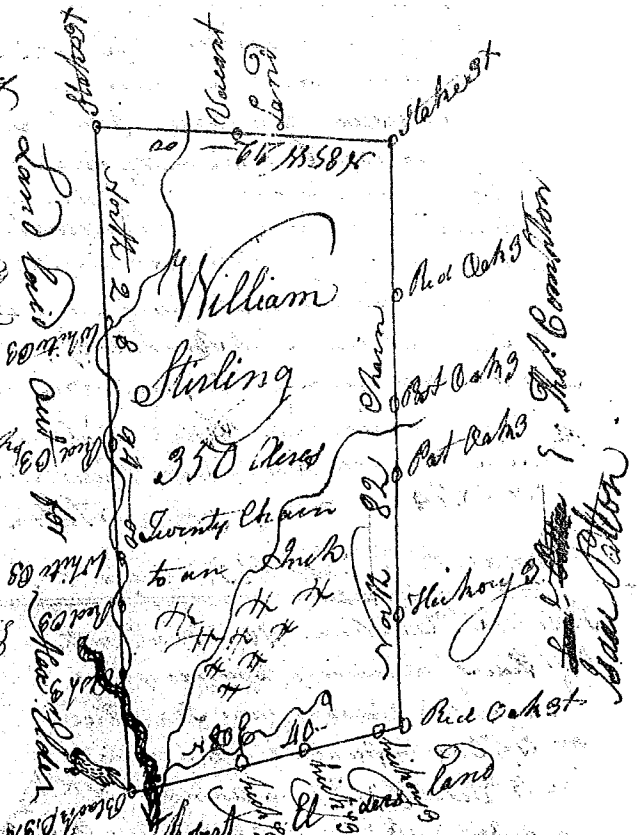

Andrew Thomson Esq^r
 Recorded the 7th January 1785
 Delivered to Wm Stirling

State of South Carolina
 Pursuant to a Warrant from John Thomas
 Esq^r & Commissioner of Locations in Ninety Six
 District No Side Saluda, I have admeasured &
 and laid out unto William Higgins a Tract of
 Land containing One hundred & sixty acres and
 Small Branch of Beaver dam Creek of Enore River
 Below the Mason Boundary Bounded W^m land
 laid out Unknown all other Sides Vacant & that
 such Shape & make as the annexed plat represents
 Survey the 2nd Nov^r 1784 Robert Hanna
 Recorded the 8th Jan^y 1785

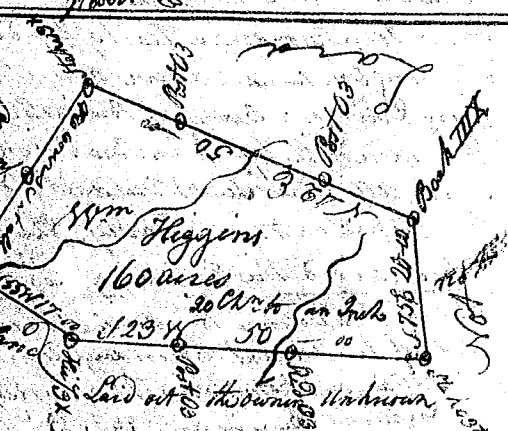

State of South Carolina Ninety Six
 District on the East side of the ancient
 Boundary line. Pursuant to a
 warrant from John Thomas Esq^r Com^r
 Location Bearing date the 15th Oct^r 1784
 I have admeasured & laid out unto
 Christoph Brandon a Tract of land
 containing two Hundred & forty acres situate
 lying land being on both sides of Fair forest
 Creek bounded N^W by James Hinsworths
 land N^E by Ed Thomas Brandons land all other
 sides old lines including a Shoat on S^W Creek
 Formerly Claim^d by James Hinsworths & that such
 Shape & make as the annexed plat represents
 Survey Oct^r 30th 1784
 155 Andrew Thomson
 Recorded the 8th Jan^y 1785



Delivered to Christoph Brandon